



Welcome Back Parent Handbook September 2020.

Welcome back to Kennington we have missed you all.

This booklet has been written to give parents the details of what the school has done to make it as safe as possible for children to return to continue their learning,

Our overriding priority is the safety and health of the children, families and staff within the school community. Every decision that we have made and every procedure we have put in place has this at the forefront. This means that there may be systems that we have put into place, which may make some things trickier. However, they are there for everyone's safety and health

We will expect all families to closely follow all social distancing rules inside and outside of school for the safety of everybody.

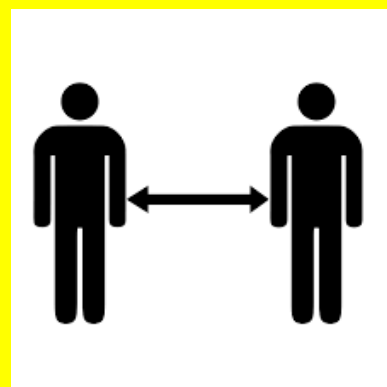

How are you making sure that the school is safe?



We will continue to evaluate the risk when we open the school



Our school is deep cleaned every night by our cleaners



Children's Bubbles will have no more than 30 children and remain with the same member off staff as best as possible.



Everyone will wash his or her hands frequently



If a child or someone in their house is ill they **CANNOT** come to school



We will make changes to the times of the school day

Does my child have to come into school?



You **Will** be fined if your child does not attend school.

What if my child has a school dinner?

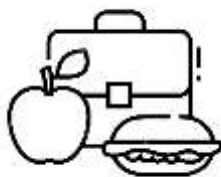

Children will go up in their bubbles to the hall to collect their school dinner and then take it back to the classroom. School dinners and packed lunches will be eaten in classrooms.

Are children wearing uniform?



Yes. When you come back in September all children are expected to be in full school uniform. This should be washed regularly

Please do not bring unnecessary bags or equipment

Please ensure children have suitable clothing for all weather.

New Safety Procedures



Drop off and pick up for all year groups

- Children need to be dropped at their allocated gate (see map) at their allocated time. They will not be able to enter via a different gate
- Parents will not be allowed on site
- If you need to speak to a teacher or the school office please email or send a clasdojo
- Pick up will also be staggered so please ensure you are prompt at your allocated gate
- Please leave your dogs at home

Be socially safe

- No parents are allowed on site
- All visitors (such as social workers and site teams) are expected to adhere to social distancing rules.
- Please pay attention to new signs around the site to maintain distance

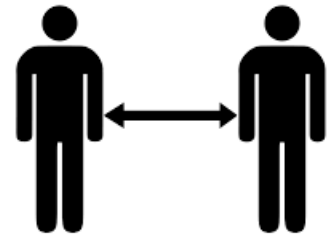

Increased Hygiene

- Children will continue to wash their hands several times a day
- Children will have hand sanitiser in each classroom and around the school
- Children will be taught how to wash their hands thoroughly for 20 seconds
- Each child will have their own stationery set supplied by the school to minimise contact
- Wipes and tissues will be supplied to every class
- Toilets will be unisex and will be allocated to each class/year group

Behaviour

- All children are expected to behave in a way that is safe and respectful
- Children must stay within their bubble and must adhere to social distancing and hygiene regimes that we have put in place
- Children who cannot adhere to this will be spoken to and parents contacted
- For further information please see our behaviour policy found on our school website.

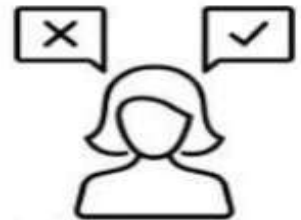

Attendance



- Children are expected to attend school daily and the school's attendance policy will be followed.
- Children are required to attend school at their allocated time, through their allocated gate. It is imperative that you bring your child to school on time every day. This is to reduce the risk of children having to go into areas, which are closed off, to them.
- Late Arrivals are to wait at the gate outside the school office until a member of the office team comes to greet them.

What will happen in a bubble?



The main safety plan is to place children into “class bubbles” where they will only see the children that are in their class. These bubbles will have no more than 30 children in each class. They will have their own learning space and we will make every effort for the “bubbles” to not come into contact with each other. All children will be encouraged and taught to stay socially distanced.

Children will stay in their bubbles and, for the time being they will have limited access to play equipment within their group. Playtimes and lunchtimes will be staggered, to ensure minimal contact with their bubbles.



Pupils will be in rows in class facing forwards

After school and breakfast club

Breakfast Club will be limiting its numbers to 32 children a day with keyworker and vulnerable children taking top priority



Children will be in year group bubbles in both breakfast club and afterschool club.

Children will come up to the serving hatch in their bubbles to pick up their food.

No Parents will be allowed in the hall.

School Map

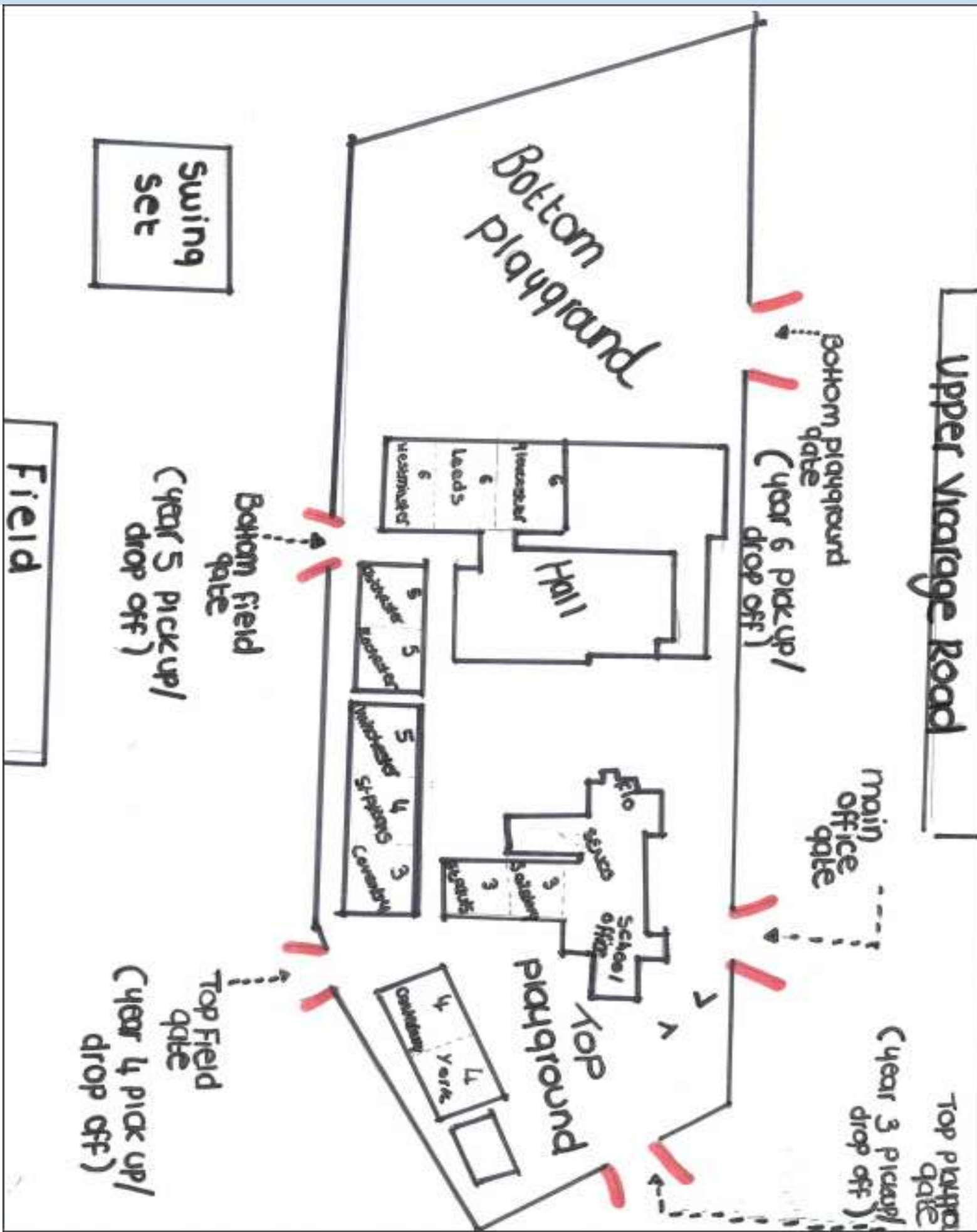

Timetable for the school day

YEAR 3

Class	DROP OFF TIME (AM)	DROP OFF GATE	LUNCHTIME	PICK UP TIME (PM)	PICK UP GATE
Coventry	08:50	Top Playground Field Gate	11:30 – 12:15 (playground)	15:00	Top Playground Field Gate
St Pauls	08:55	Top Playground Gate	11:30 – 12:15 (Quiet Area)	15:05	Top Playground Gate
Salisbury	09:00	Top Playground Gate	11:45 – 12:30 (Quiet Area)	15:10	Top Playground Gate

YEAR 4

CLASS	DROP OFF TIME (AM)	DROP OFF GATE	LUCHTIME	PICK UP TIME (PM)	PICK UP GATE
Canterbury	09:05	Top Playground Field Gate	11:45-12:30 (Playground)	15:10	Top Playground Field Gate
York	08:45	Top Playground Gate	12:15 – 13:00 (Playground)	15:00	Top Playground Gate
St Albans	08:55	Top Playground Field Gate	12:15 – 13:00 (Quiet Area)	15:05	Top Playground Field Gate

Year 5

CLASS	DROP OFF TIME (AM)	DROP OFF GATE	LUCHTIME	PICK UP TIME (PM)	PICK UP GATE
Winchester	08:55	Bottom Playground Field Gate	11:45 – 12:30 (Playground- ½)	15:05	Bottom Playground Field Gate
Chichester	09:00	Bottom Playground Field Gate	11:45 – 12:30 (Playground- ½)	15:10	Bottom Playground Field Gate
Rochester	09:05	Bottom Playground Field Gate	12:15 – 13:00 (Playground- ½)	15:15	Bottom Playground Field Gate

Year 6

CLASS	DROP OFF TIME (AM)	DROP OFF GATE	LUCHTIME	PICK UP TIME (PM)	PICK UP GATE
Westminster	08:55	Bottom Playground Gate	12:15 – 13:00 (Playground ½)	15:05	Bottom Playground Gate
Leeds	09:00	Bottom Playground Gate	12:45 – 13:30 (Playground ½)	15:10	Bottom Playground Gate
Gloucester	09:05	Bottom Playground Gate	12:45 – 13:30 (playground ½)	15:15	Bottom Playground Gate

